



MACO Manufacturing



Library/Media Center Furnishings

Science & Educational Casework

Product Profile



20 Year Warranty

▶ Focus on the K – 12 market

- Library



- Media

- Technology



- Educational Casework



Successful projects start with the Design

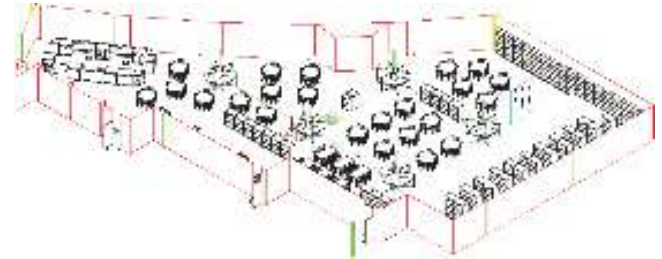
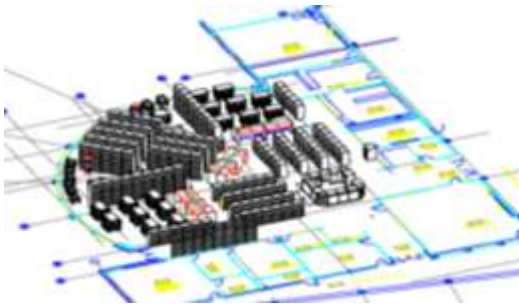

- ▶ We offer a complete layout and design service
- ▶ Special Product offerings with FSC certification to contribute LEED points
- ▶ We have an experienced staff that can assist you with exciting layouts that meet the requirements and expectations of today's educators

Superior Products begin with Superior Equipment

- ◉ UV Finishing Line
 - Ensures that all finishes are consistent in color
 - Environmentally responsible 100% solids exceed AWI standards
 - No formaldehyde, VOCs, or VHAPs present in coating system
 - Exceeds standards set by LEED for emission and EQC4 indoor air quality for school environments
- ◉ CNC Machines ensure precise cuts on patterns for consistency in construction
- ◉ Automated Edge banders ensure proper placement and adhesion for years of use.
- ◉ High-capacity panel saws create economies of scale and help to smooth production flow



CHOOSE YOUR STYLE

- ▶ Traditional to Contemporary and everything in between



Alpha Series



Franklin Series



Momentum Series

LIBRARY SHELVING

- ▶ **Designer Series**
 - **Hardwood, Multi-Ply Veneer Core**
- ▶ **Traditional**
 - **Solid Oak Lumber**
- ▶ **Macotherm**
 - **Melamine Construction**
- ▶ **Available with 18 gauge powder coated Steel Shelves**



DESIGNER SERIES

- ▶ Our most popular and widely used product line
- ▶ Constructed of multi-ply hardwood veneer core
- ▶ Integral backs included
- ▶ Features full 1" construction on the following:
 - End panels
 - Intermediate panels
 - Shelves
 - Top
 - Base



- Green Product, constructed of materials that are CARB compliant and FSC certified, with core veneers from sustainable plantations

TRADITIONAL SERIES

- ▶ Solid oak construction using select red oak lumber
- ▶ Dovetail joinery
- ▶ Features a 3/4" and 1" construction which is detailed below
 - End panels- 1"
 - Intermediate panels- 1"
 - Shelves- 3/4"
 - Base- 3/4"
 - Tops- 3/4"



MACOTHERM SHELVING AND BOOKCASES



- ▶ Budget conscious product
- ▶ Same 1" construction as the Designer series
- ▶ All components are constructed of thermofused melamine
- ▶ Stocking 4 standard wood grain finishes : Fusion Maple, Solar Oak, Wild Cherry and Nepal Teak
- ▶ Special orders available in many different wood grains and solid colors

TABLE CONSTRUCTION



- ▶ Tables are available in a variety of sizes and shapes
- ▶ All tabletops are 1 1/8" thick CARB compliant combination core MDF and veneer core substrate
- ▶
- ▶ The top is laminated with high-pressure laminate
- ▶ Legs are 2-1/4" square one piece solid northern red oak consistent in color and equipped with 1-1/2" diameter adjustable glides

TABLE LEG ATTACHMENT AND APRON DETAIL

- ▶ Complete metal to metal attachments utilizing BOTH a steel plate and a corner brace. (Most manufacturers use one or the other)



TABLE EDGE BANDING OPTIONS

- ▶ Four standard edge bands are available
 - TE-100: 3mm solid oak (3mm PVC for Macotherm)
 - TE-200: 1 ¼" solid oak external bullnose
 - TE-250: 1 ½" solid oak external bullnose
 - TE-350: 1 ¼" Franklin



TE-100



TE-200



TE-250



TE-350

TECHNOLOGY-FRIENDLY



Computer Stations with built-in wire chases include lockable access doors



Circulation Desks have full wire access via removable panels. Cutouts are provided in the bottom panels and the ends to allow easy flow and access to power and data connections

TAKE A CLOSER LOOK



Environmentally-driven manufacturing



- U.V. Finishing
- Custom Design Services
- Table Construction
- 20 Year Warranty
- New Designs and Products



A wide variety of finishes and laminates for the look you want

